

Collets & Applications

Basic dimensions to help identify collets,
I will add to the list as I find data...

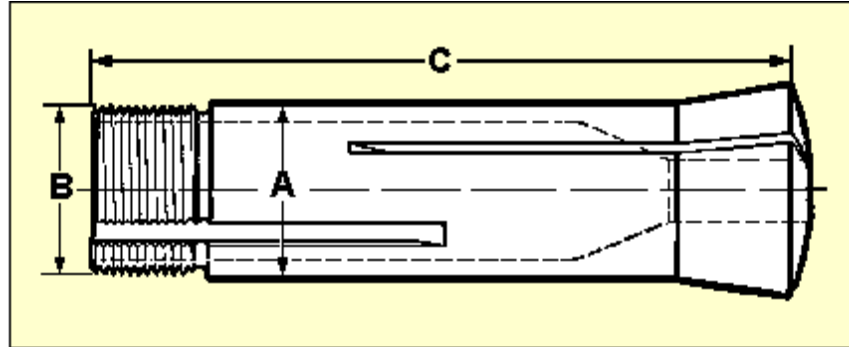

Hardinge Collet No.	Standard Collet	Maximum Capacity in Inches			Major Dimensions in Inches		
		Round	Square	Hexagon	Body A	Thread B	Length C
3AM	Ames 5/8 Inch Cap.	5/8	7/16	17/32	0.750	.745-24-RH	3-3/16
1AM	Ames 1 Inch Cap.	1	23/32	7/8	1.125	1.120-24-RH	3-29/32
3AT	Atlas	1/2	11/32	7/16	0.687	.645-26-RH	2-5/16
2B	Becker No. 2	1/2	11/32	7/16	0.590	.437-26-RH	2-1/32
2AB	Becker No. 2A	9/16	25/64	31/64	0.750	.500-20-RH	2-9/16
3B	Becker No. 3	3/4	17/32	21/32	0.875	.625-16-RH	3-7/16
1C	Cataract No. 1	1/4	11/64	7/32	0.335	.325-40-RH	1-7/16
3C	Cataract No. 3	1/2	11/32	7/16	0.650	.645-26-RH	2-11/16
4C	Cataract No. 4	3/4	17/32	21/32	0.950	.945-20-RH	3
5C	Cataract No. 5	1-1/16	3/4	29/32	1.250	1.245-20-RH	3-9/32
115	Cushman No. 115	1-1/8	51/64	31/32	1.344	1.312-20-LH	3-1/2
215	Cushman No. 215	1-3/4	1-7/32	1-1/2	2.030	2.000-18-LH	4-3/4
2H	Hendey No. 2	5/8	7/16	17/32	0.826	.812-20-RH	4-1/4
3H	Hendey No. 3	7/8	5/8	3/4	1.125	1.062-20-RH	4-7/16
6H	Hendey No. 6	1-1/8	51/64	31/32	1.375	1.312-20-RH	4-3/4
8H	Hendey No. 8	1-1/4	7/8	1-1/16	1.500	1.437-20-RH	4-3/4
2L	LeBlond No. 2	3/4	17/32	21/32	0.950	.945-20-RH	3
6L	LeBlond No. 6	1	23/32	7/8	1.250	1.187-20-RH	4-7/16
1K	Kearney & Trecker	1	23/32	7/8	1.250	No Thread	2-1/2
10L	LeBlond No. 10	1-1/4	7/8	1-1/16	1.562	1.500-18-RH	5-1/2
3PN	Pratt & Whitney #3NS	1/2	11/32	7/16	0.650	.645-24-RH	2-1/16
4PN	Pratt & Whitney # 4	3/4	17/32	21/32	1.000	.995-16-RH	2-29/32
5PN	Pratt & Whitney # 5	1	23/32	7/8	1.312	1.307-16-RH	3-13/32
5P	Pratt & Whitney # 5	5/8	7/16	17/32	0.812	.807-24-RH	3-11/16
7P	Pratt & Whitney # 7	7/8	5/8	3/4	1.125	1.120-20-RH	4-3/4
10P	Pratt & Whitney # 10	1-1/4	7/8	1-1/16	1.500	1.495-20-RH	4-3/4
2VB	Reed Prentice # 2V	1/2	11/32	7/16	0.595	.437-26-RH	2-7/16
3NS	Rivett No. 3NS	1/2	11/32	7/16	0.687	.650-20-RH	2-7/8
40S	Rivett No. 40S	1/2	11/32	7/16	0.750	.670-20-RH	2-25/32

4NS	Rivett No. 4NS	5/8	7/16	17/32	0.826	.812-20-RH	3-1/2
5NS	Rivett No. 5NS	7/8	5/8	3/4	1.062	1.050-20-RH	4-7/32
4C	Rockwell 10"	3/4	17/32	21/32	0.950	.945-20-RH	3
2S	Seneca No. 2	9/16	25/64	31/64	0.750	.745-18-RH	3-15/64
3S	Seneca No. 3	3/4	17/32	21/32	1.000	.995-20-RH	4-19/32
1J	Sjogren No. 1	1	3/4	7/8	1.250	1.245-20-RH	3
2J	Sjogren No. 2	1-3/8	31/32	1-3/16	1.625	1.620-18-RH	3-1/4
3J	Sjogren No. 3	1-3/4	1-7/32	1-1/2	2.000	1.995-20-RH	3-3/4
5SC	Sloan & Chace # 5	3/8	17/64	21/64	0.600	.500-26-RH	2-7/16
52SC	Sloan & Chace # 5-1/2	5/8	7/16	17/32	0.800	.795-20-RH	3-11/16
1A	South Bend No. 1A	1/2	11/32	7/16	0.650	.645-26-RH	2-9/16
2A	South Bend No. 2A	11/16	15/32	19/32	0.860	.850-20-RH	3-5/16
32S	Stark No. 3-1/2	1/2	11/32	7/16	0.703	.695-24-RH	2-9/16
4S	Stark No. 4	3/4	17/32	21/32	0.998	.988-20-RH	3-3/4
42S	Stark No. 4-1/2	1	23/32	7/8	1.250	1.245-20-RH	3-11/16
5V	Van Norman No. 5	5/8	7/16	17/32	0.850	.772-18-RH	3-7/8
20V	Van Norman No. 112	1	23/32	7/8	1.250	No Thread	3-11/16
8WN	Wade American # 8	1	32/32	7/8	1.250	1.245-16-RH	3-7/8

Index