

Venturi and Prop Driver From alloy

Venturi

Fix venturi to the nose with Devcon or 24 hour Araldite

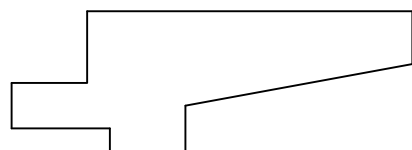
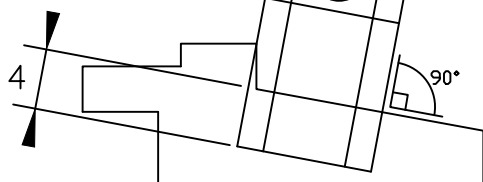

Section through nose

Side view

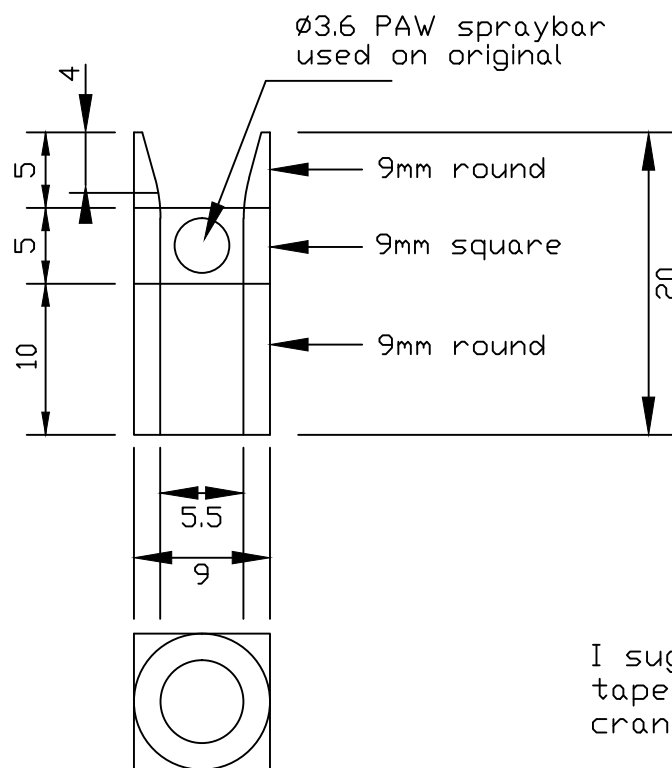

End view

Prop Driver

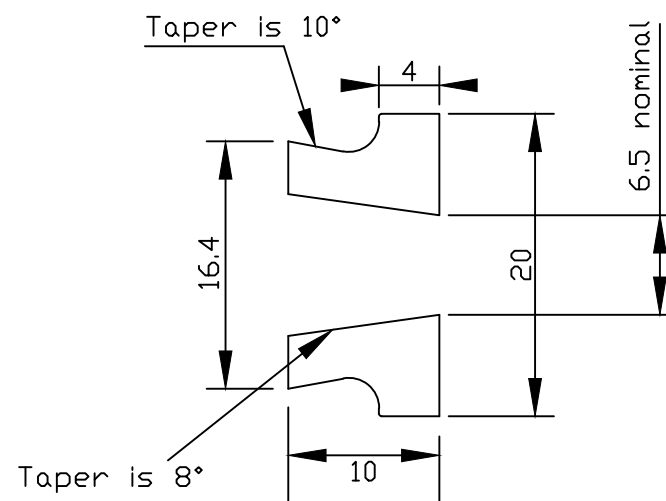

I suggest machining the prop driver taper immediately after making the crankshaft for perfect mating

All drawings 2 x actual size

Materials as stated

Sheet 7 of 9

Holly Buddy 2.5cc diesel engine

Designed by Ed Holly

CAD by Steve Jenkinson