

Frame

Modifed C-Channel (mild steel)

Shown with optional
rounding of corners

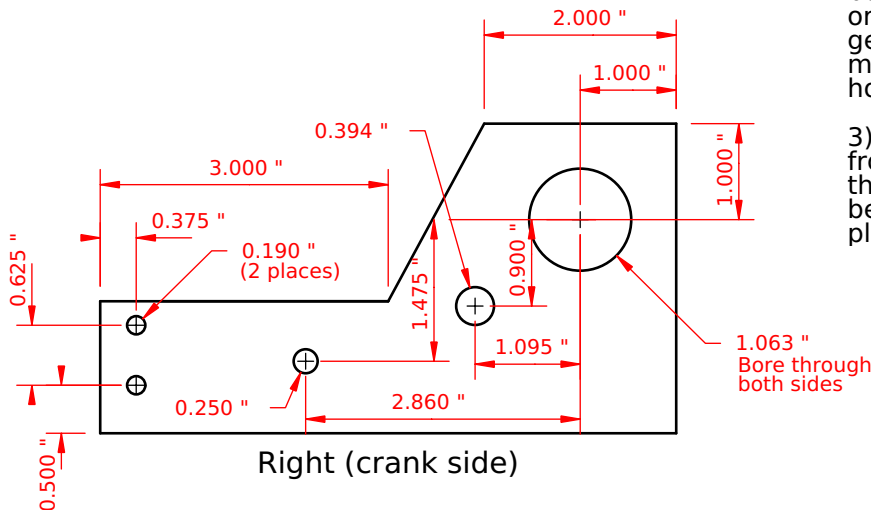
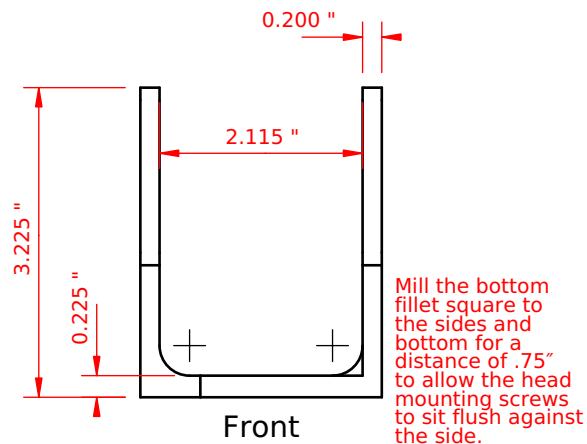
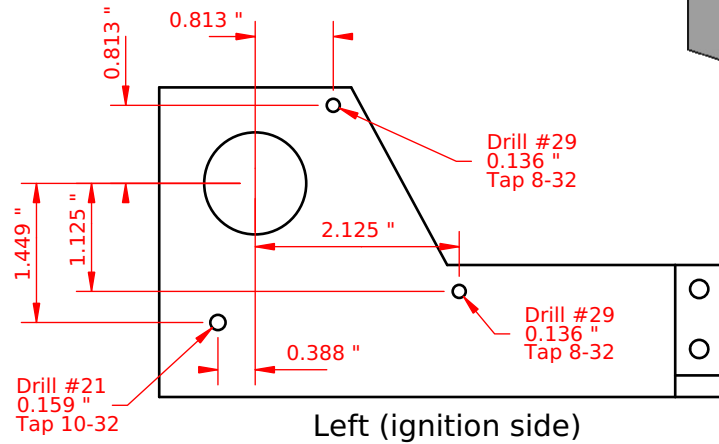
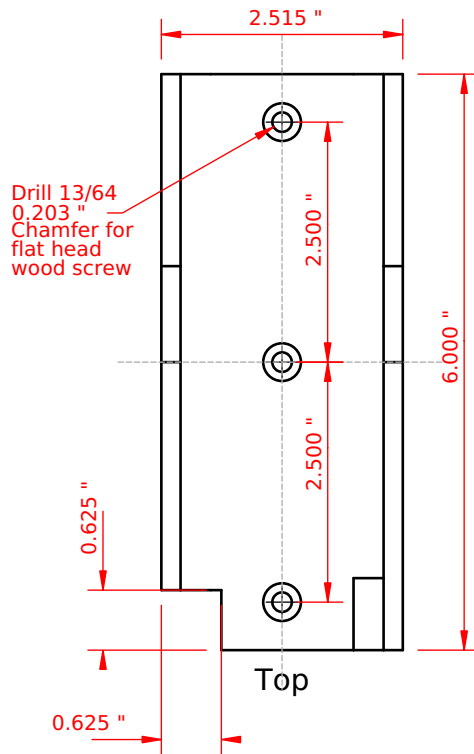
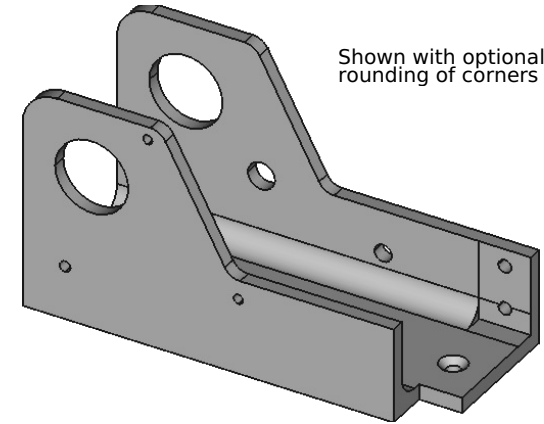

Notes:

- 1) Except for the main bore, holes shown are drilled through one side only.
- 2) The main bore (through both sides) serves as the origin point for the cam gear mount, rocker arm mount, and points mount holes.
- 3) The 0.625" notch in the front left corner will hold the gas tank mount; it will be welded or epoxied in place.

Designed by Andrew H. Wakefield	Scale 1:2	Default Dim. +/- .001"	Title Steel Webster	Sheet 1	Revision 3.5	Date 3/13/2020
------------------------------------	--------------	---------------------------	------------------------	------------	-----------------	-------------------